

# Wolfking®\* (CFS) - Style Grinder Plates & Knives

*Wolfking®\* - style 250mm and 400mm grinder accessories*

**PRIME**Edge carries a wide range of plates, knife holders and insert blades for Wolfking® grinders, all manufactured to exact specifications for perfect fit and function.

**PRIME**Edge also offers premium quality parts for Seydelmann, Krämer & Grebe, Alexanderwerk, Laska and Velati meat grinders.

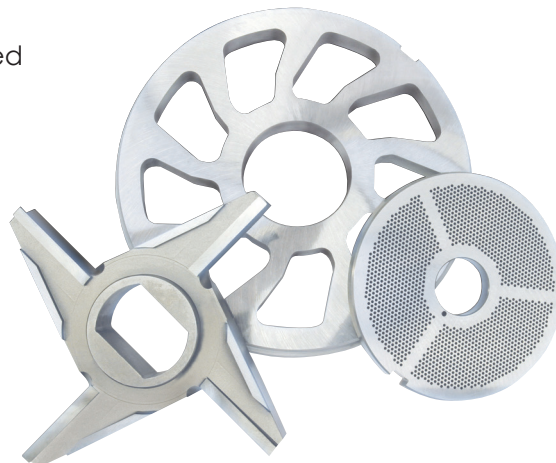

**PRIME**Edge®  
COZZINI CUTTING EDGES  
AND SHARPENING SOLUTIONS

## Wolfking®\* - style 250mm accessories

| Description                   | Wolfking Part No. | PRIMEEdge Part No. |
|-------------------------------|-------------------|--------------------|
| Propeller knife, 3-arm        | 30008             | GW-30008           |
| Knife, solid 8-arm            | 30011             | GW-30011           |
| Knife holder, 8-arm           | 30012             | GW-30012           |
| Star knife, 4-arm             | 30014             | GW-30014           |
| Knife insert (set of 8)       | 30061             | GW-30061           |
| Hole plate, 3.2mm             | 30088             | GW-30088           |
| Hole plate, 4.0mm             | 30089             | GW-30089           |
| Hole plate, 13mm              | 30094             | GW-30094           |
| Precutter plate, 5-hole       | 30236             | GW-30136           |
| Precutter plate, 10-hole      | 30143             | GW-30143           |
| Precutter plate, fixed 7-hole | 30888             | GW-30888           |

## Wolfking®\* - style 400mm accessories

| Description                    | Wolfking Part No. | PRIMEEdge Part No. |
|--------------------------------|-------------------|--------------------|
| Hole plate 13mm                | 30104             | GW-30104           |
| Precutter plate, 5-hole        | 30138             | GW-30138           |
| Precutter plate, fixed 9-hole  | 30139             | GW-30139           |
| Precutter plate, 10-hole       | 30140             | GW-30140           |
| Knife, solid 8-arm             | 30171             | GW-30171           |
| Insert, for 8-arm knife holder | 39441             | GW-39441           |
| Knife holder, 8-arm            | 39446             | GW-39446           |

**PRIME**Edge®  
COZZINI CUTTING EDGES  
AND SHARPENING SOLUTIONS

877-322-EDGE(3343) • [primedge.com](http://primedge.com) • [sales@primedge.com](mailto:sales@primedge.com) • Fax:224-265-6638

# Wolfking®\* (CFS) - Style Grinder Replacement Parts

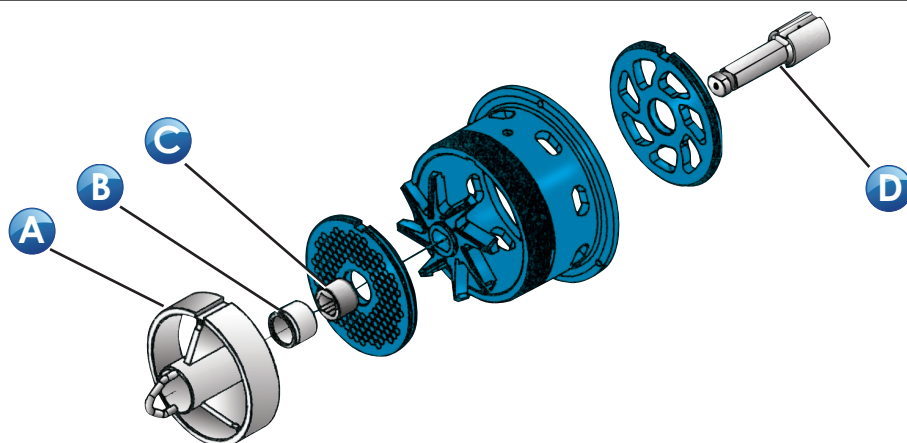

## Replacement parts for the 250mm Wolfking® - style grinder

| Description |                              | PRIMEEdge<br>Part No. |
|-------------|------------------------------|-----------------------|
| A           | Pilot bearing housing        | GW-30351              |
| B           | Steel lining (pilot bearing) | GW-30033              |
| C           | Nut (pilot bearing)          | GW-30005              |
| D           | Stud                         | GW-30024              |

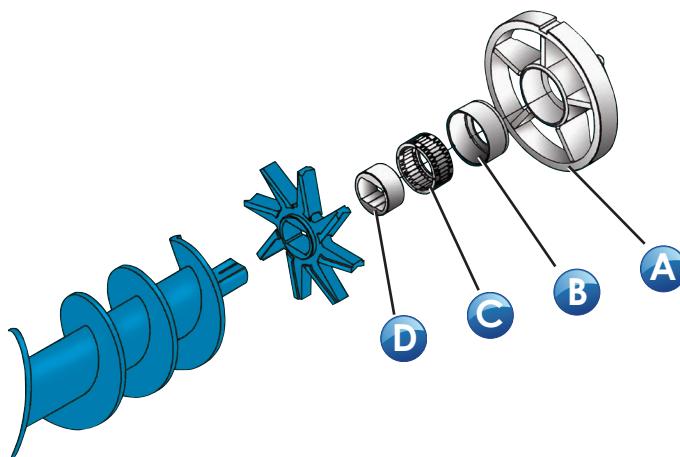

## Replacement parts for the 400mm Wolfking® - style grinder

| Description |                       | PRIMEEdge<br>Part No. |
|-------------|-----------------------|-----------------------|
| A           | Pilot bearing housing | GW-30351              |
| B           | Pilot bearing bushing | GW-30033              |
| C           | Roller bearing        | GW-32549              |
| D           | Pilot bearing nut     | GW-32551              |

**PRIMEEdge®**  
COZZINI CUTTING EDGES  
AND SHARPENING SOLUTIONS

877-322-EDGE(3343) • [primedge.com](http://primedge.com) • [sales@primedge.com](mailto:sales@primedge.com) • Fax:224-265-6638

PRIMEEdge, Inc. • Cutting Edges • Knife Sharpening Systems • Edge Maintenance Tools • Professional Sharpening Services  
Circular Blade & Grinder Plate Sharpeners • Grinder Plates, Knives & Accessories • Sanitizer/Bacteria Reduction Washing Systems

\*All items, parts, and accessories listed on this sheet are manufactured by PRIMEEdge, Inc., or manufactured to PRIMEEdge, Inc.'s specifications. All original equipment manufacturer's names are listed with an asterisk (\*) to indicate that these items are manufactured by PRIMEEdge, Inc., and not the original equipment manufacturer. The names of the original equipment manufacturers referred to on this site are all registered trademarks of their respective companies. Unless specifically stated otherwise, PRIMEEdge, Inc. has no association or affiliation with any entities listed here on.